

REVISIONS	
No.	

THESE DRAWING & SPECIFICATIONS ARE INSTRUMENTS OF SERVICE AND SHALL REMAIN THE PROPERTY OF ROSARIO MONTERO WHETHER THE PROJECT FOR WHICH THEY WERE PREPARED IS EXECUTED OR NOT, THEY ARE NOT TO BE USED IN ANY MANNER ON OTHER PROJECTS OR EXTENSIONS TO THIS PROJECT EXCEPT BY AGREEMENT IN WRITING AND WITH THE APPROPRIATE COMPENSATION TO ROSARIO MONTERO & ASSOCIATES

Project information:
INTERIOR RENOVATIONS FOR EXISTING WAREHOUSE
 OWNER INFORMATION:
VALPART ENTERPRISES LLC
 PROJECT ADDRESS:
 10200 NW 25TH ST UNIT 113
 DORAL, FL 33172
 This item has been digitally signed and sealed by ROSARIO MONTERO, PE, on 05/05/2024. Printed copies of this document are not considered signed and the signature must be verified on any electronic copies

ROSARIO MONTERO
 PROFESSIONAL ENGINEER, PE.
 FL REGISTRATION No. 78464
 9581 FONTAINEBLUE BULD
 MIAMI, FLORIDA 33172
 PHONE: (786) 294-8305

DATE: 07.22.2024
 DRAWN BY: R.G.
 CHECKED BY: R.M.
 SCALE: AS SHOW

M-1

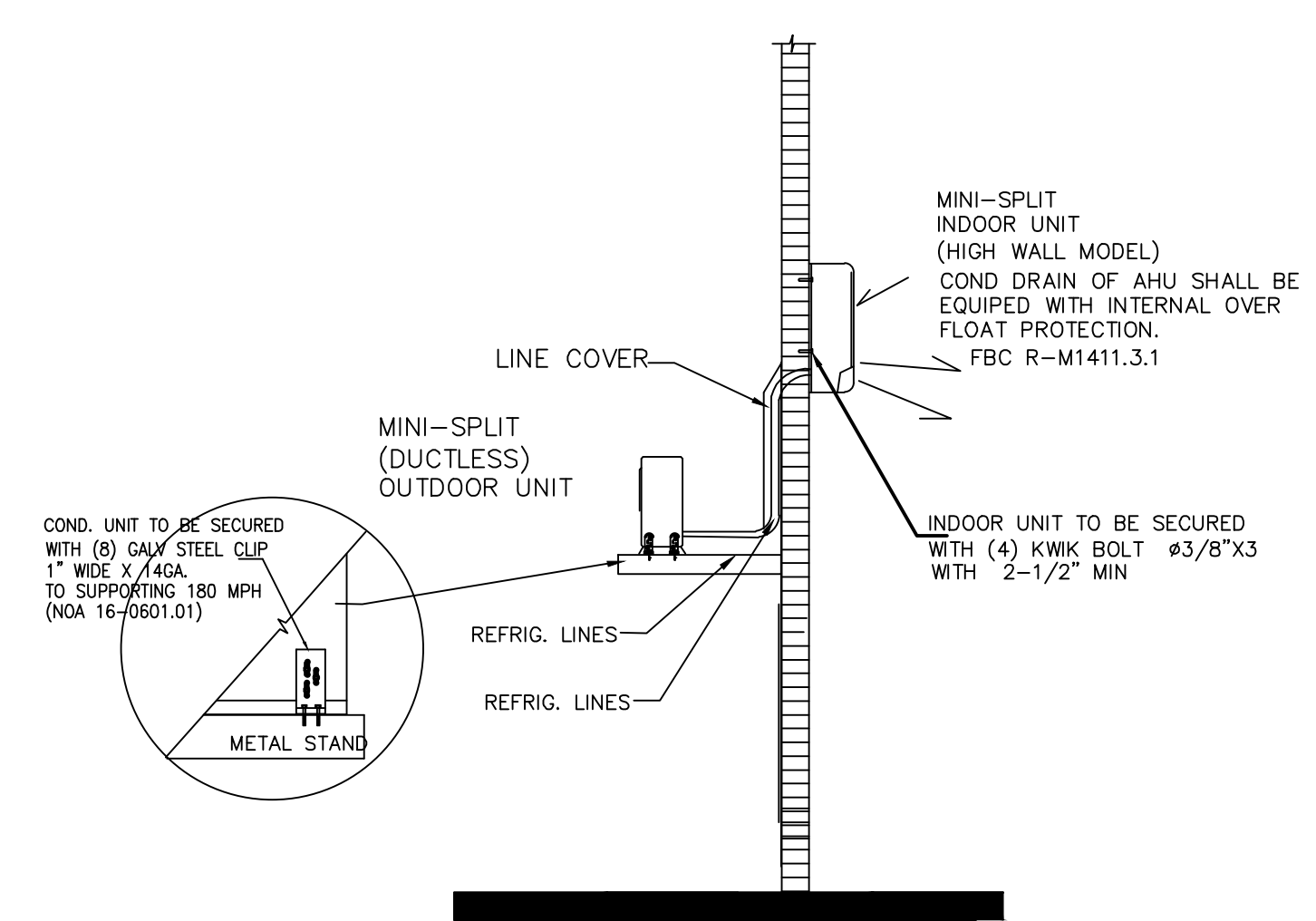

MINI-SPLIT -WALL MOUNTING DET.
 SCALE: N.T.S.

A/C UNIT SCHEDULE# 1	
CU MODEL NO.	MULTI-SPLIT (HEAT PUMP) A16CM4H4R18
AHU MODEL NO.	(A) A16EW4H4R12 (B) A16EW4H4R09
DESIGN MANUFACTURER	AIR-CON OR EQUAL APPROVED
COOLING TOTAL CAPACITY, MBH	18000
COOLING SENSIBLE CAPACITY, MBH	13500
HEATING CAPACITY, MBH	19000
SUPPLY (CFM) AHU A / AHU B	340 CFM / 290 CFM
SEER	16
HSPF	8.2
POWER SUPPLY V/PH/Hz	230/1/60
COND UNIT MCA	14 A
REFRIG. SUCT/LIQ.	(1) 3/8" / 1/4" (1) 3/8" / 1/4"
REFRIGERANT	R-410
C/U WEIGHT	115 LBS
ENTERING AIR TEMP. F DB/WB	80/67
AMBIENT AIR TEMP. F DB	95

SCOPE OF WORK:
 - IS LIMITED TO INSTALL A NEW UNIT AS SPECIFIED IN THESE PLANS.
 - EXISTING WAREHOUSE AREA IS NOT PART OF SCOPE OF WORK.

ALL WORK SHALL CONFORM WITH THE CURRENT (FBC 2021, 7th EDITION), NFPA, NEC, AND ALL OTHER APPLICABLE FEDERAL, STATE AND LOCAL REGULATIONS AND ORDINANCES.

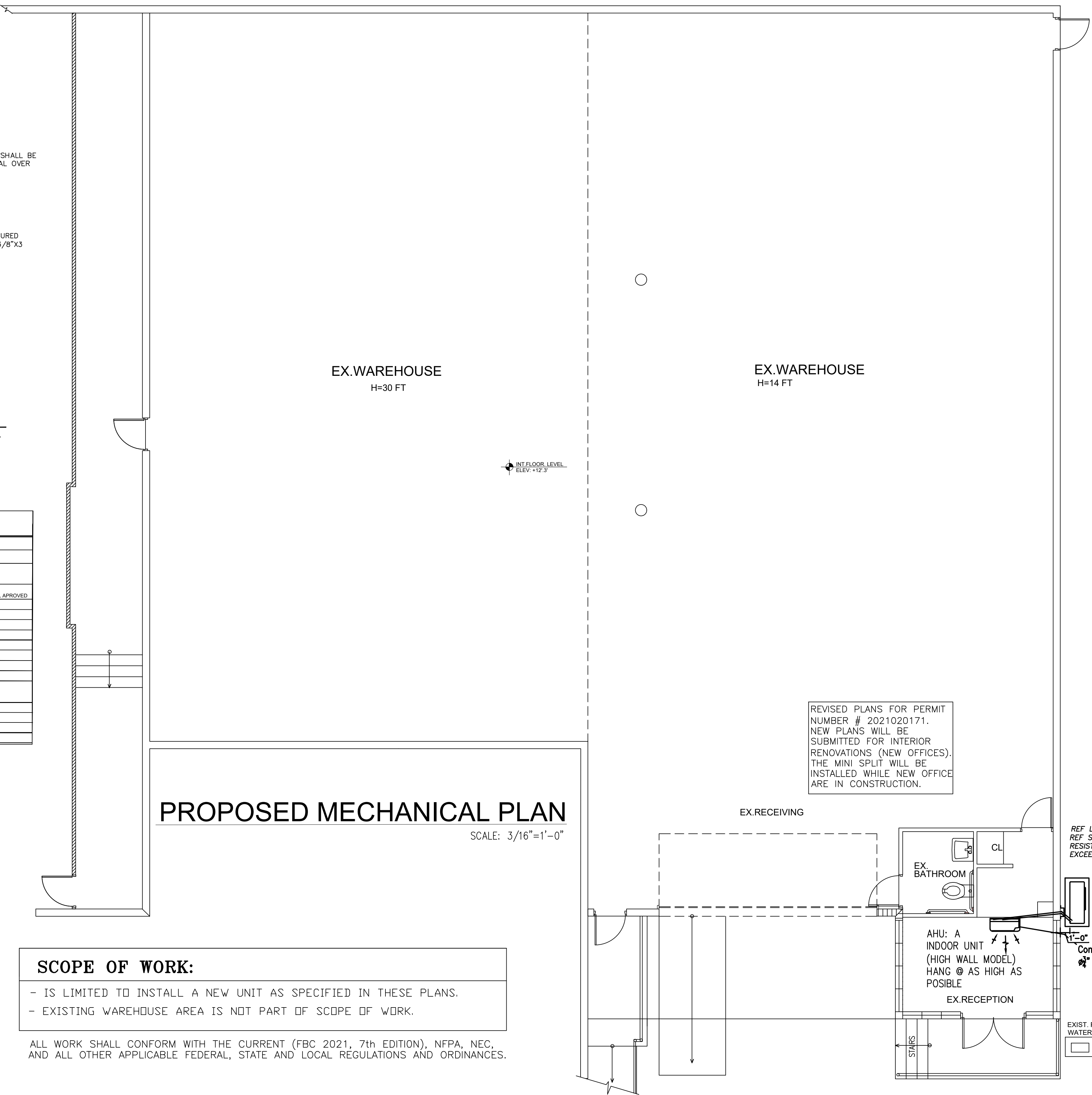

PROPOSED MECHANICAL PLAN
 SCALE: 3/16"=1'-0"

INT FLOOR LEVEL
 ELEV. +12.3'