

REVISIONS	
No.	

THESE DRAWING & SPECIFICATIONS ARE INSTRUMENTS OF SERVICE AND SHALL REMAIN THE PROPERTY OF ROSARIO MONTERO WHETHER THE PROJECT FOR WHICH THEY WERE PREPARED IS EXECUTED OR NOT. THEY ARE NOT TO BE USED IN ANY MANNER ON OTHER PROJECTS OR EXTENSIONS TO THIS PROJECT EXCEPT BY AGREEMENT IN WRITING AND WITH THE APPROPRIATE COMPENSATION TO ROSARIO MONTERO & ASSOCIATES

Project Information:
INTERIOR RENOVATIONS FOR EXISTING WAREHOUSE
 OWNER INFORMATION:
VALPART ENTERPRISES LLC
 PROJECT ADDRESS:
 10200 NW 25TH ST UNIT 113
 DORAL, FL 33172
This item has been digitally signed and sealed by ROSARIO MONTERO, PE, on 05/05/2024. Printed copies of this document are not considered signed and the signature must be verified on any electronic copies

ROSARIO MONTERO
 PROFESSIONAL ENGINEER, P.E.
 FL REGISTRATION No. 78464
 9581 FONTAINEBLUE BULD
 MIAMI, FLORIDA 33172
 PHONE: (786) 294-8305

DATE: 07.22.2024
 DRAWN BY: R.G.
 CHECKED BY: R.M.
 SCALE: AS SHOW

EXISTING CONDITIONS:

- EXISTING WORK NOT SPECIFIED FOR REMOVAL THAT IS TEMPORARILY REMOVED, DAMAGED, EXPOSED, OR IN ANY WAY DISTURBED OR ALTERED BY REMOVAL WORK SHALL BE REPAIRED, PATCHED, OR REPLACED.
- INSPECT EXISTING CONDITIONS OF THE WORK, INCLUDING ELEMENTS SUBJECT TO DAMAGE OR TO MOVEMENT DURING CUTTING AND PATCHING. AFTER UNCOVERING WORK, INSPECT CONDITIONS AFFECTING INSTALLATION OF PRODUCTS OR PERFORMANCE OF WORK.
- REPORT UNSATISFACTORY OR QUESTIONABLE CONDITIONS TO A/E IMMEDIATELY. DO NOT PROCEED WITH THE WORK UNTIL A/E HAS EVALUATED AND PROVIDED FURTHER INSTRUCTIONS.
- PROVIDE ADEQUATE TEMPORARY SUPPORT AS NECESSARY TO ENSURE STRUCTURAL INTEGRITY OF THE WORK.
- THE CONTRACTOR SHALL PROVIDE DEVICES AND METHODS TO PROTECT OTHER PORTIONS OF THE WORK FROM DAMAGE. PROVIDE PROTECTION FROM ELEMENTS FOR PORTIONS OF THE WORK EXPOSED BY CUTTING AND PATCHING WORK. EXECUTE CUTTING AND DEMOLITION BY METHODS PREVENTING DAMAGE TO OTHER WORK AND PROVIDING PROPER SURFACES TO RECEIVE INSTALLATION OF NEW WORK.
- REFINISH ENTIRE SURFACES AS NECESSARY TO PROVIDE AN EVEN FINISH TO MATCH ADJACENT FINISHES. EXECUTE FITTING AND ADJUSTMENT OF PRODUCTS TO PROVIDE A FINISHED INSTALLATION TO COMPLY WITH SPECIFIED PRODUCTS, FUNCTIONS, TOLERANCES, AND FINISHES.
- EXISTING WORK MAY BE CUT, ALTERED, REMOVED, OR TEMPORARILY REMOVED AND REPLACED AS NECESSARY FOR THE PERFORMANCE OF WORK REQUIRED. EXCEPTION: UNLESS OTHERWISE INDICATED ON DRAWINGS, DO NOT CUT OR ALTER STRUCTURAL MEMBERS WITHOUT AUTHORIZATION BY THE A/E.
- THE CONTRACTOR SHALL COVER OR FILL ALL HOLES AND OTHER HAZARDOUS OPENINGS CREATED BY REMOVAL WORK.
- RESTORE DAMAGED OR DEFACED AREAS OR ITEMS, REMAINING IN PLACE, OF WORK PERFORMED UNDER THIS CONTRACT TO COMPARABLE CONDITIONS EXISTING BEFORE THE WORK.
- ALL WORK SHALL COMPLY WITH THE NEW CODES FLORIDA BUILDING CODE, 2010 EDITION OF FBC INCLUDING THE FLORIDA EXISTING BUILDING CODE-FEBC, RESIDENTIAL NEW CODE AND ALL LOCAL ORDINANCES GOVERNING.
- CONTRACTOR SHALL VERIFY ALL DIMENSIONS AND CONDITIONS AND NOTIFY THE ARCHITECT OF ANY DISCREPANCIES BEFORE STARTING THE WORK.
- CONTRACTOR SHALL BE RESPONSIBLE FOR COMPLIANCE WITH ALL SAFETY RELATED O.S.H.A. REQUIREMENTS DURING CONSTRUCTION.
- ALL WORK SHALL BE PERFORMED BY A LICENSED AND INSURED STATE CERTIFIED GENERAL CONTRACTOR OR BY THE OWNER IF APPROVED BY THE LOCAL BUILDING DEPARTMENT OFFICIAL.

DEMOLITION:

- ORGANIZE AND PERFORM DEMOLITION WORK TO AVOID DAMAGE TO CONSTRUCTION INTENDED TO REMAIN.
- DEMOLITION AND TRANSPORTATION OF DEBRIS SHALL COMPLY WITH APPLICABLE CODES AND REGULATIONS COVERING THESE OPERATIONS. FEES SHALL BE PAID BY THE CONTRACTOR.
- DEMOLITION AND REMOVAL OPERATIONS SHALL BE CONDUCTED IN AN EXPEDIENT MANNER, WITH PRECAUTIONS TAKEN TO PREVENT DEMOLITION SITE FROM BEING AN "ATTRACTIVE NUISANCE".
- PERFORM REMOVAL WORK INDICATED ON DRAWINGS IN AN ORDERLY MANNER ACCORDING TO ACCEPTED CONSTRUCTION. PROTECT WORK SPECIFIED TO REMAIN. PROTECT ADJACENT AREAS FROM DAMAGE OR UNDUE DIRT AND DUST. WET DOWN DEBRIS OR RUBBISH, IF NECESSARY, TO MINIMIZE FLYING DUST.
- THESE DEMOLITION PLAN DRAWINGS WERE CREATED FROM EXISTING WORKING DRAWINGS AND ARE INTENDED TO SHOW THE GENERAL CONDITIONS WHICH ARE EXPECTED TO OCCUR. VERIFY ALL CONDITIONS BEFORE PROCEEDING WITH THE DEMOLITION WORK IN ANY AREA. DEMOLITION OF DOORS, WINDOWS, FINISHES, PARTITIONS, OR ANY OTHER NONSTRUCTURAL ITEMS MAY PROCEED AS INDICATED. WHERE DISCREPANCIES INVOLVE STRUCTURAL ITEMS, REPORT SUCH DIFERRENCES TO THE ARCHITECT AND SECURE INSTRUCTIONS BEFORE PROCEEDING IN THE AFFECTED AREA.
- THE CONTRACTOR SHALL REMOVE EXISTING WALLS AND OTHER ASSOCIATED CONSTRUCTION AS INDICATED ON THE PLANS.
- THE CONTRACTOR SHALL PROVIDE ALL NECESSARY BARRICADES AND OTHER FORMS OF PROTECTION TO PROTECT THE OWNER'S PERSONNEL, OTHER TENANTS AND GENERAL PUBLIC FROM INJURY DUE TO DEMOLITION WORK.
- THE CONTRACTOR SHALL ENSURE THAT DEMOLITION WORK DOES NOT INTERFERE WITH OR PROHIBIT THE CONTINUING OCCUPATION OF ADJACENT OPERATIONS WITHIN THE STRUCTURE. THIS INCLUDES BUT IS NOT LIMITED TO THE SELECTIVE DEMOLITION OF PARTITIONS, ELECTRICAL, AND MECHANICAL SYSTEMS. THE CONTRACTOR SHALL INFORM THE OWNER OF A MINIMUM OF 72 HOURS OF DEMOLITION ACTIVITIES THAT WILL AFFECT NORMAL OPERATION OF THE BUILDING.
- THE CONTRACTOR SHALL REPAIR DAMAGES CAUSED TO ADJACENT FACILITIES BY DEMOLITION WORK.

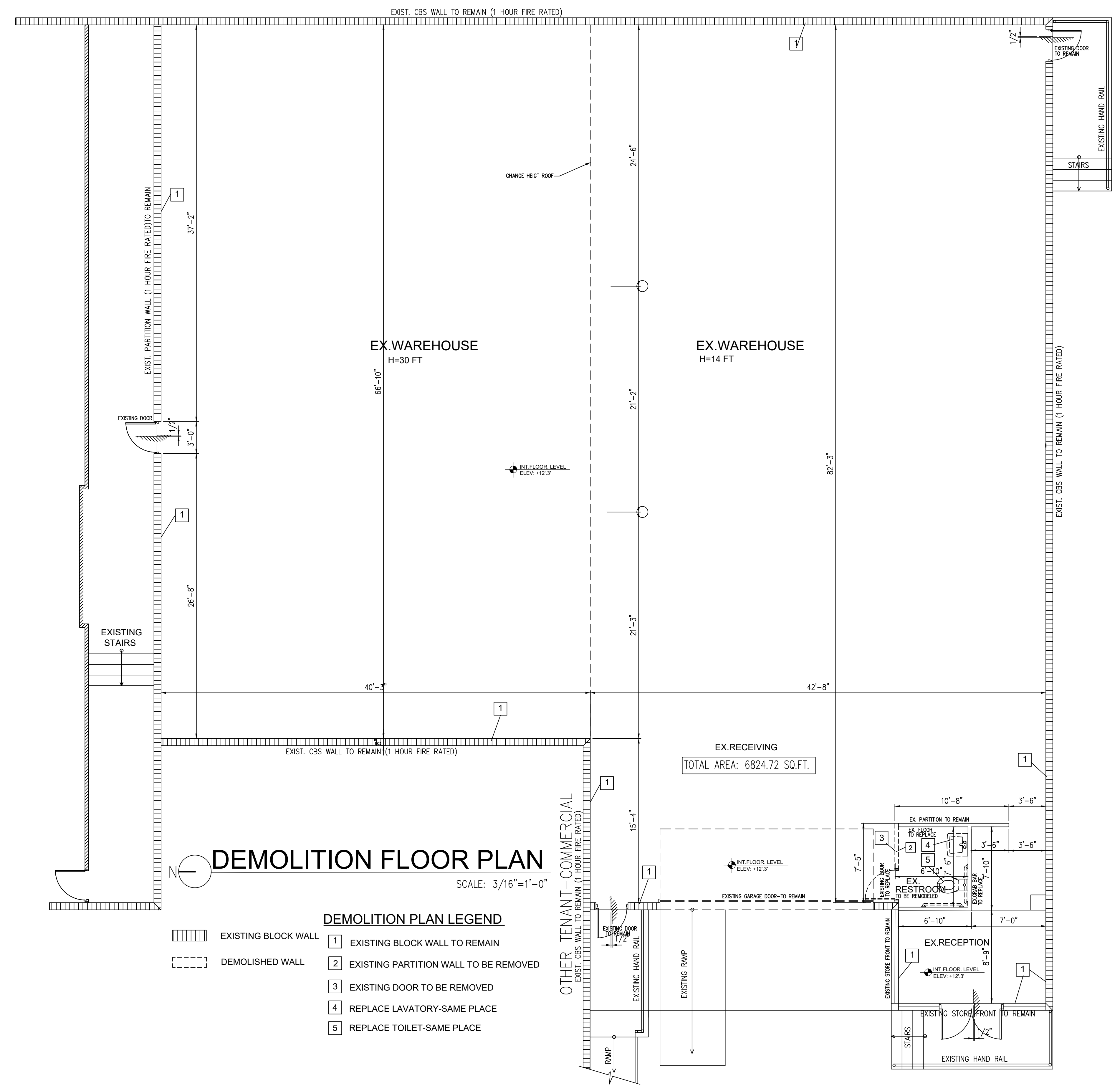

DEMOLITION FLOOR PLAN
 SCALE: 3/16"=1'-0"

- DEMOLITION PLAN LEGEND**
- | | | | |
|--|-----------------------------|--|---------------------------------------|
| | EXISTING BLOCK WALL | | EXISTING BLOCK WALL TO REMAIN |
| | DEMOLISHED WALL | | EXISTING PARTITION WALL TO BE REMOVED |
| | EXISTING DOOR TO BE REMOVED | | REPLACE LAVATORY-SAME PLACE |
| | REPLACE TOILET-SAME PLACE | | |